

D-Code One Piece Toilet # 011301..01 / 011301..82 / 011301..82

| < 15 1/2 " > |

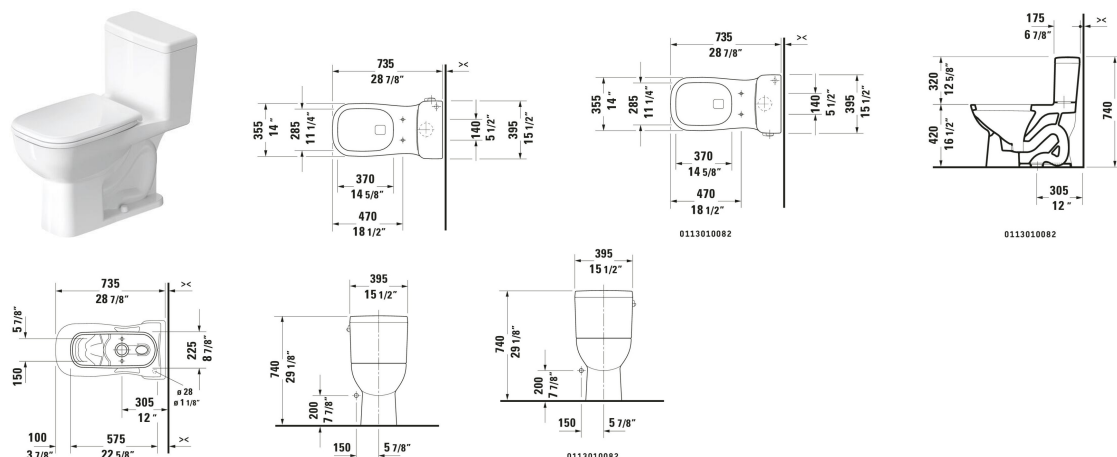

One Piece Toilet	Dimension	Weight	Order number
28 7/8 ", elongated, Flush water quantity: 1.28 gal, Siphonic, Flushing rim: Closed, Outlet: vertical, Rough-in: 12 ", ADA: Yes, cUPC listed: Yes			
Colors			
00 White 20 HygieneGlaze (an antibacterial ceramic glaze that provides almost indefinite effectiveness)			
Variant			
White High Gloss, Single Flush, Trip lever placement: Left, WaterSense: Yes	15 1/2 "x29 1/8 "	87.016 lb	011301..01
White High Gloss, Single Flush, Trip lever placement: Right, WaterSense: Yes	15 1/2 "x29 1/8 "	86.862 lb	011301..82
White High Gloss, HygieneGlaze, Single Flush, Trip lever placement: Right, WaterSense: Yes	15 1/2 "x29 1/8 "	86.862 lb	011301..82
Spare parts			
Installation Set One Piece Toilet, Toilet Bowl	2 3/8 x 5 1/8 "	1.499 lb	001431
Suitable products			
Toilet Seat Slow close: No, Hinge material: Stainless Steel, elongated, 14 1/8 x 18 3/4 "	14 1/8 x 18 3/4 "		006741
Toilet Seat Slow close: Yes, Removable Seat, Hinge material: Stainless Steel, elongated, 14 1/4 x 18 7/8 "	14 1/4 x 18 7/8 "		006209
One Piece Toilet Set items: One Piece Toilet, Toilet Seat, Article No.: 0113010082, 0062090096, White High Gloss, elongated, Siphonic, Flushing rim: Closed, Outlet vertical, Single Flush, Trip lever placement: Right, Flush water quantity: 1.28 gal, Single Flush, Trip lever placement: Right, 15 1/2 x 28 7/8 "			D40059

D-Code One Piece Toilet # 011301..01 / 011301..82 / 011301..82

|< 15 1/2 " >|

All drawings contain the necessary measurements which are subject to standard tolerances. They are stated in inch & mm and are non-binding. Exact measurements, in particular for customized installation scenarios, can only be taken from the finished ceramic piece.